

# EXAM ROOM 01

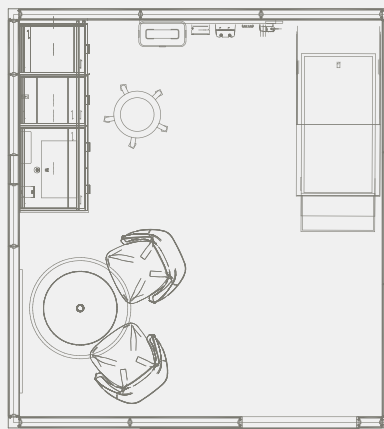

Support all your speech privacy needs.  
Whether it's a telehealth consult or in-person care.

**Not just built for today.  
Building for tomorrow.**



PLAN VIEW

## SYSTEM FEATURES

|    |                                   |
|----|-----------------------------------|
| 01 | 4" Solid Walls                    |
| 02 | Infection Control Gaskets         |
| 03 | Casework                          |
| 04 | Willow® Glass                     |
| 05 | Integrated Technology             |
| 06 | Electrical                        |
| 07 | Integrated Medical Accessory Rail |
| 08 | Integrated Plumbing               |

# INTENSIVE CARE ROOM 01



Create a functional, future-ready space with durable, easy-to-clean materials for enhanced infection prevention. Removable panels allow access to the wall cavity for easy maintenance and equipment upgrades.

**Not just built for today.  
Building for tomorrow.**

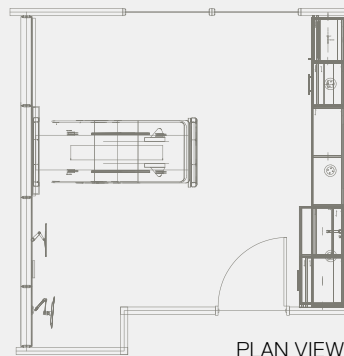

## SYSTEM FEATURES

|    |                                   |
|----|-----------------------------------|
| 01 | 4" Solid Walls                    |
| 02 | Casework                          |
| 03 | Infection Control Gaskets         |
| 04 | Flexible Medical Gas              |
| 05 | Integrated Medical Accessory Rail |
| 06 | Electrical                        |
| 07 | Integrated Technology             |
| 08 | Writable Surface                  |

# INFUSION BAY 01



Define patient spaces. Leverage easily repeatable solutions to gain efficiency without sacrificing personalized expression.

**Not just built for today.  
Building for tomorrow.**



PLAN VIEW

## SYSTEM FEATURES

|    |                                   |
|----|-----------------------------------|
| 01 | 4" Solid Walls                    |
| 02 | Infection Control Gaskets         |
| 03 | Casework                          |
| 04 | Electrical                        |
| 05 | Felxible Medical Gas              |
| 06 | Integrated Medical Accessory Rail |